



*'Tradie Tuff'*

# COMMERCIAL ROOF RACKS

**MAZDA** BT50 CREW CAB, 20 - on

FIXED MOUNT

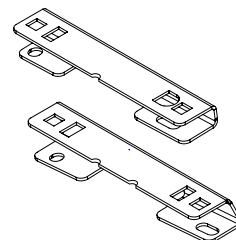

PART NUMBER: VAS.RC1148, VAS.RA1148, VAS.RC1149, VAS.RA1149, VAS.RC1146, VAS.RA1146, VAS.RC1147, VAS.RA1147.

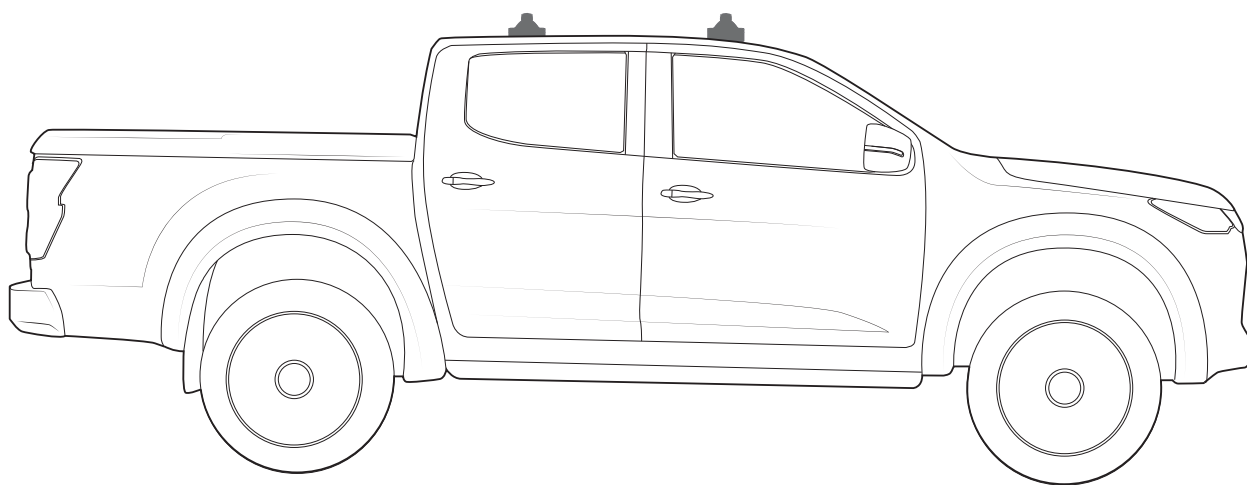

**Note:**

- PLEASE READ INSTRUCTIONS AND CHECK CONTENT PRIOR TO INSTALLING.
- PLACE INSTRUCTIONS IN VEHICLES GLOVE COMPARTMENT AFTER INSTALLING.



2 Bar maximum capacity: 100kg

Tested to AS/NZS 1235-2000 ADR standards

- Please check your vehicle's manual for vehicle load capacity (please do not exceed the lowest load rating) and please download and read our Load Rating guide which can be found on our website [vas.com.au](http://vas.com.au).
- Load rating is based on driving on sealed roads to road conditions and includes weight of the roof rack system.

# Important information

- Complete maintenance checks weekly including bolt connections and tightness.
- Heavy loads carried near feet
- Overhanging loads should conform to relevant state laws
- Check tie down strap tension every 50klm as loads can shift
- Specialised equipment carriers such as ladder slides should be used
- Ensure your roof racks, ladder rails and or load does not inhibit the tailgate lifting on vehicles manufactured with these doors
- Check car park heights before entering
- Keep load under the maximum capacity
- Use non stretch fastening straps
- Remove roof racks prior to using an automatic car wash

**Note:** The handling characteristics of a vehicle will change when a carrier system is fitted. Driving technique such as speed reduction, cornering techniques and braking distances should be altered to allow for these changes.

## Kit Inclusions

Item	Part Description	Qty
1	Front Right Bracket - C345FR	1
2	Front Left Bracket - C345FL	1
3	Rear Right Bracket - C346RR	1
4	Rear Left Bracket - C346RL	1
5	Ditch Fill Bracket Front - C605	2
6	Ditch Fill Bracket Front - C606	2
7	M8 x 20mm Socket Head Screw - F019	4
8	M8 x 17 Spring Washer - F018	4
9	M8 x 17 Flat washer - F017	4
10	Allen Key (8mm) - F064	1

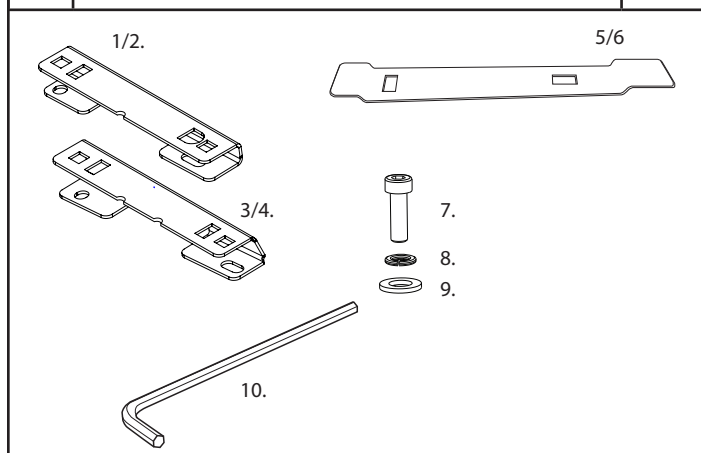

## Tools Required

A - Marker.  
B - Nylon scrape.  
C - Trim removal tools  
(rail removal only).  
D - Dremel/ dye grinder  
E - Butyl mastic.

### Required kits (as separate):

Crossbar x3

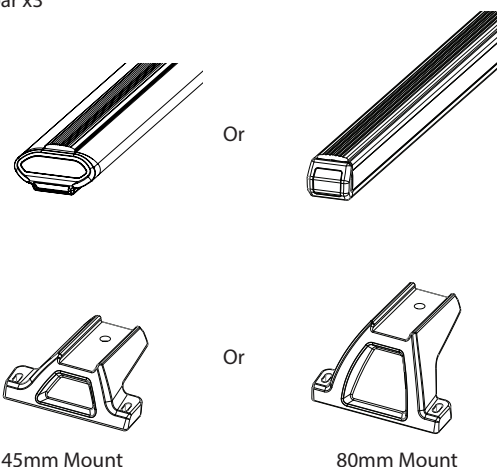

### Step 1

- 1 - Move to the roof of the vehicle.
- 2 - Create references in the ditch at the measurements shown.
- 3 - Using masking tape, line the outsides of the ditch, either side at the references.

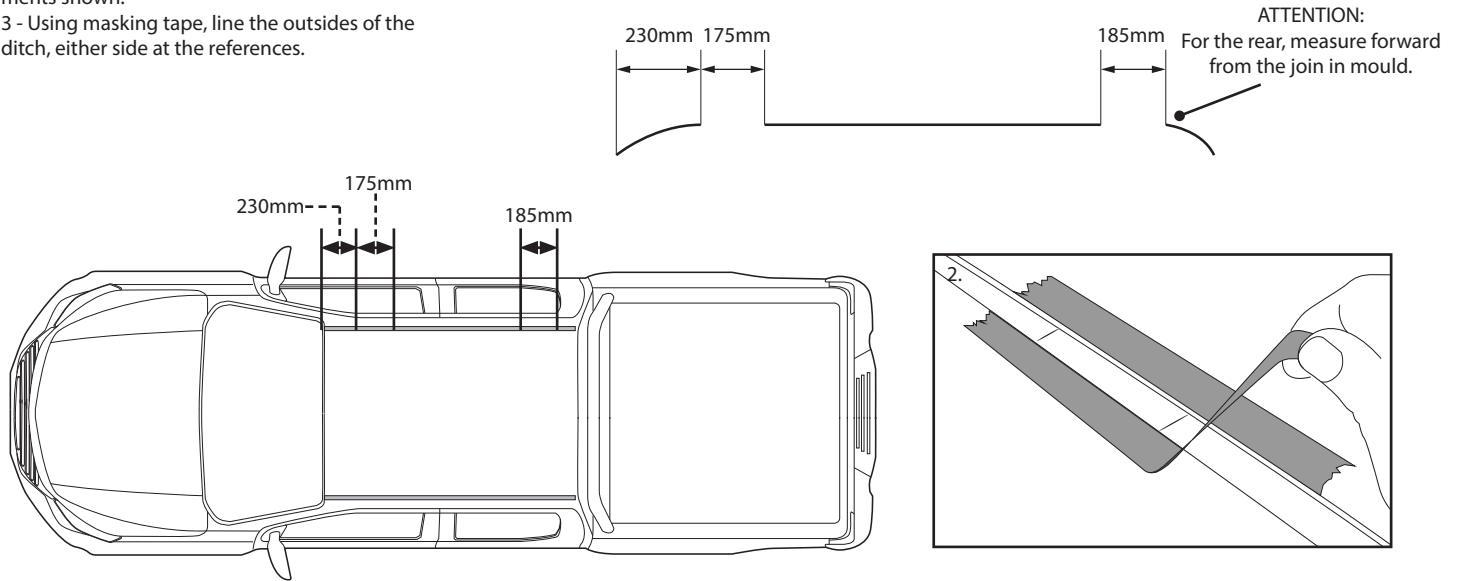

### Step 2

- With a few layers of tape either side, carefully cut through the ditch fill along the bracket width marks using a dremel. Remove the cut sections, then using a nylon scrape, clear any remaining material.

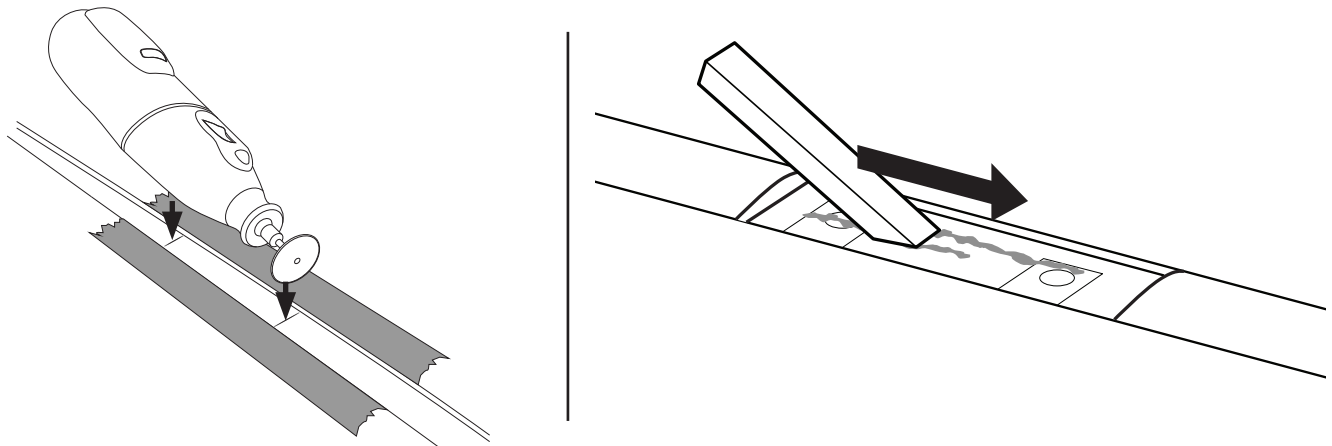

### Step 3

- Locate the factory mount points, covered with butyl patches. **Note that these patches may be painted.** Using the allen key provided, carefully puncture the **centre of the rear patch only**, exposing the thread below. Apply butyl mastic to the exposed thread.

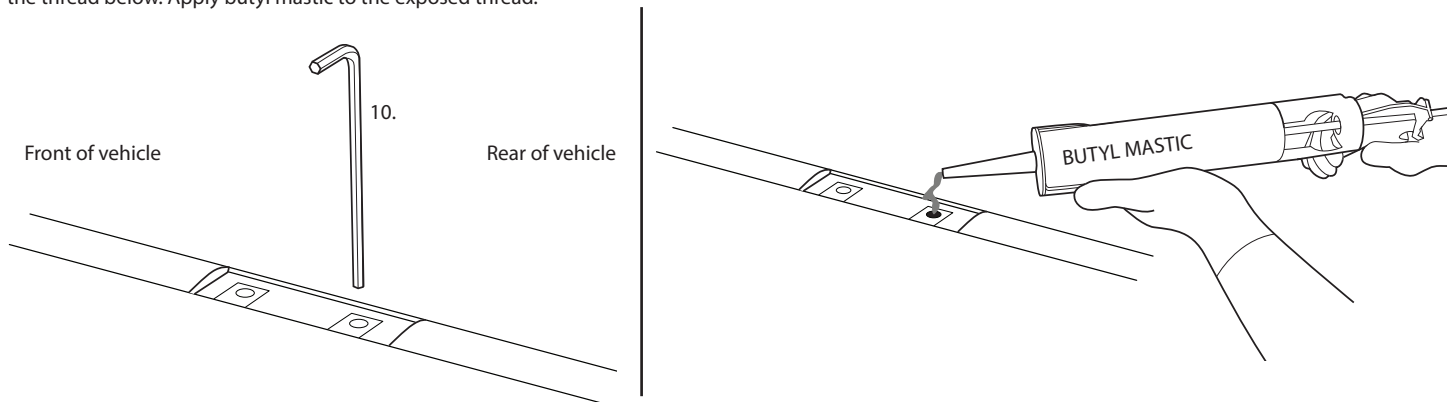

#### Step 4

- 1 - Insert the M8 hardware into the brackets.
- 2 - Place the ditch fill brackets into place as shown.

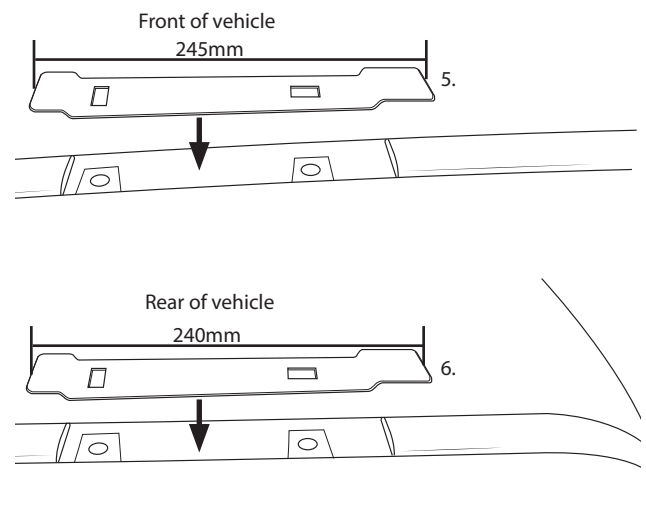
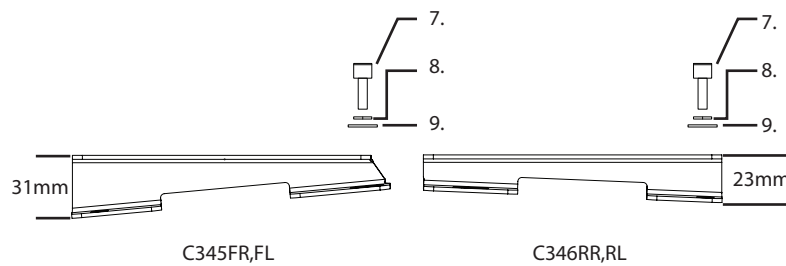

#### Step 5

Put the brackets into position and tighten with the allen key provided. Be aware of bracket orientation.

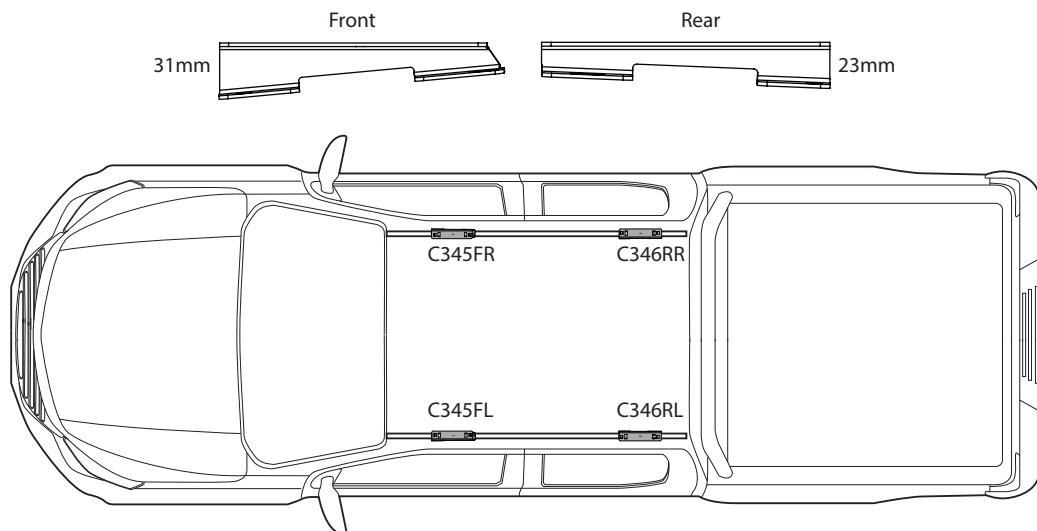

#### Step 6

Complete crossbar mount kits as specified in their instructions. Place the crossbars onto the installed brackets in the roof. Fix in place with the M6 hardware provided and tighten with an allen key.

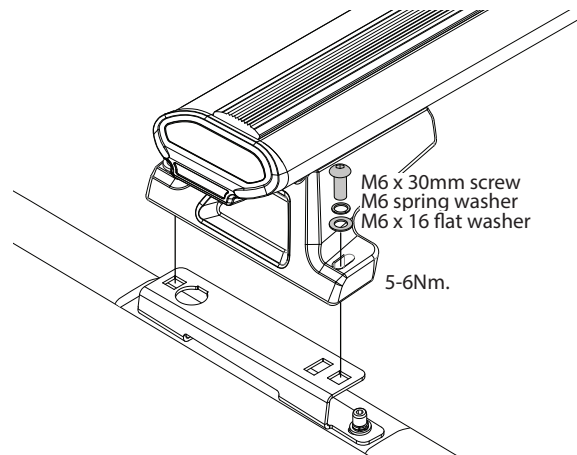
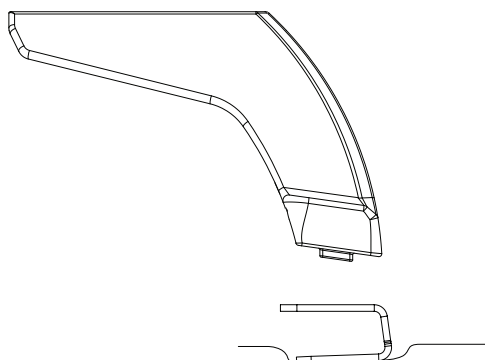

Be sure all fixtures are secure before driving the vehicle.