

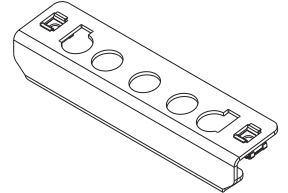

*'Tradie Tuff'*

# COMMERCIAL ROOF RACKS

**RENAULT** MASTER X62 L2H2, L3H2 10/2011 - ON  
SWB,MWB,LWB & ELWB



FIXED MOUNT

PART NUMBER: VAS.RC1078, VAS.RA1078, VAS.RC1087, VAS.RA1087, VAS.RC1076, VAS.RA1076, VAS.RC1027, VAS.RA1027, VAS.RC1083, VAS.RA1083, VAS.RC1009, VAS.RA1009, VAS.RC1050, VAS.RA1050, VAS.RC1051, VAS.RA1051.

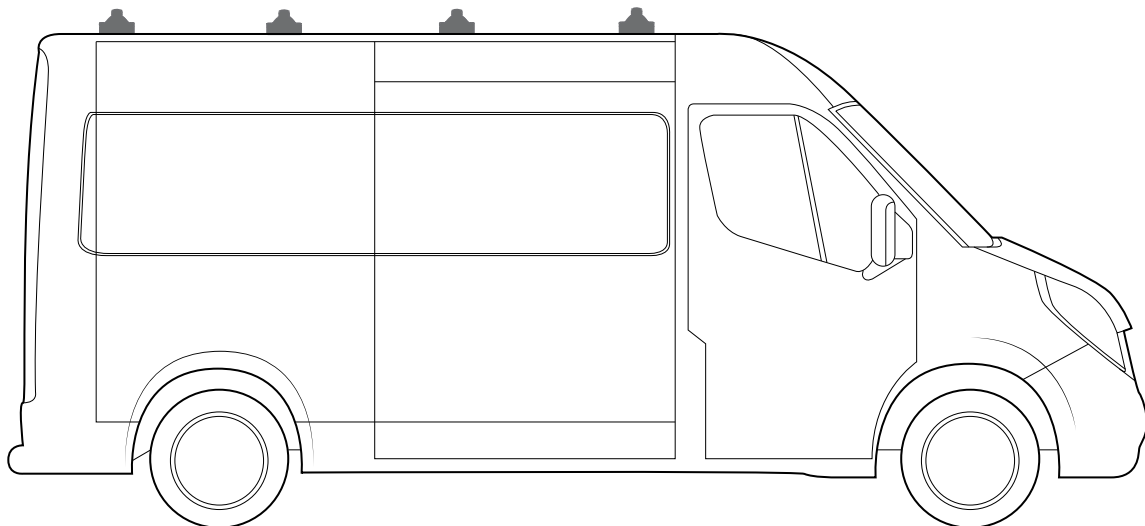

**Note:**

- PLEASE READ INSTRUCTIONS AND CHECK CONTENT PRIOR TO INSTALLING.
- PLACE INSTRUCTIONS IN VEHICLES GLOVE COMPARTMENT AFTER INSTALLING.



3 Bar maximum capacity: 100kg  
4 Bar maximum capacity: 100kg  
Tested to AS/NZS 1235-200 ADR standards

- Please check your vehicle's manual for vehicle load capacity (please do not exceed the lowest load rating) and please download and read our Load Rating guide which can be found on our website [vas.com.au](http://vas.com.au).
- Load rating is based on driving on sealed roads to road conditions and includes weight of roof rack system.

# Important information

- Complete maintenance checks weekly including bolt connections and tightness.
- Heavy loads carried near feet
- Overhanging loads should conform to relevant state laws
- Check tie down strap tension every 50klm as loads can shift
- Specialised equipment carriers such as ladder slides should be used
- Ensure your roof racks, ladder rails and or load does not inhibit the tailgate lifting on vehicles manufactured with these doors
- Check car park heights before entering
- Keep load under the maximum capacity
- Use non stretch fastening straps
- Remove roof racks prior to using an automatic car wash

**Note:** The handling characteristics of a vehicle will change when a carrier system is fitted. Driving technique such as speed reduction, cornering techniques and braking distances should be altered to allow for these changes.

## Kit Inclusions

| Item | Part                               | 3 Bar | 4 Bar |
|------|------------------------------------|-------|-------|
| 1    | M6 x 30mm Button Head Screw - F008 | 12    | 16    |
| 2    | M6 x 20mm Button Head Screw - F006 | 12    | 16    |
| 3    | M6 x 16mm Flat Washer - F011       | 24    | 32    |
| 4    | M6 Nyloc Nut - F052                | 12    | 16    |
| 5    | Common Bracket - C087              | 6     | 8     |
| 6    | M6 Spring Washer - F012            | 12    | 16    |
| 7    | 4mm Allen Tool - C028              | 1     | 1     |

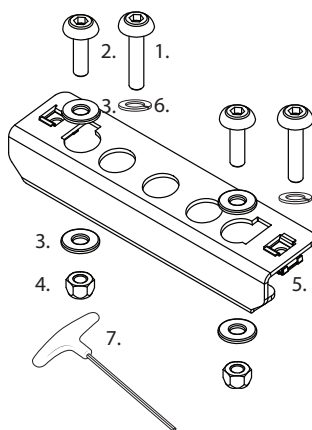

Note: The factory plugs are not used for this kit. Higher strength and better performance can be found in the roof ditch area, where multiple layers are located.

## Tools Required

- 1 - Power Drill.
- 2 - Drill Depth Guide.
- 3 - Cold Galvanising Paint.
- 4 - Butyl Mastic.
- 5 - Marker.
- 6 - Vacuum.
- 7 - 6.5mm Drill Bit.
- 8 - 10mm Wrench.
- 9 - Masking Tape.
- 10 - 3mm Pilot Drill Bit.
- 11 - 4mm Allen Key (provided).

### Required kits (as separate):

- Crossbar x 3 1500mm
- Crossbar Mount Kit x 3

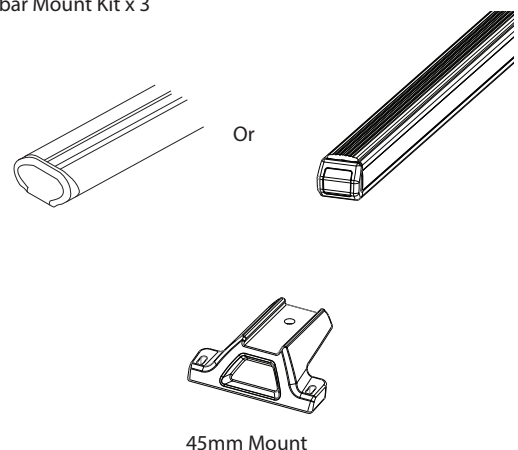

## VAS

21 Hallmark Street, Pendle Hill  
 NSW 2145, Australia  
 +61 2 9631 0555  
 vas.com.au

### 3 Crossbar System Step 1 (for 4 crossbar go to page 4).

Move to the roof of the vehicle. At the measurements indicated, place a bracket.

**Front bracket** - The rear hole of the bracket lines up with the second roof plug, from the front of the vehicle.

**Middle bracket** - Line the centre of the bracket, 235mm backward from the fourth roof plug, from the front of the vehicle.

**Rear bracket** - Centre the bracket, between the two rear roof plugs.

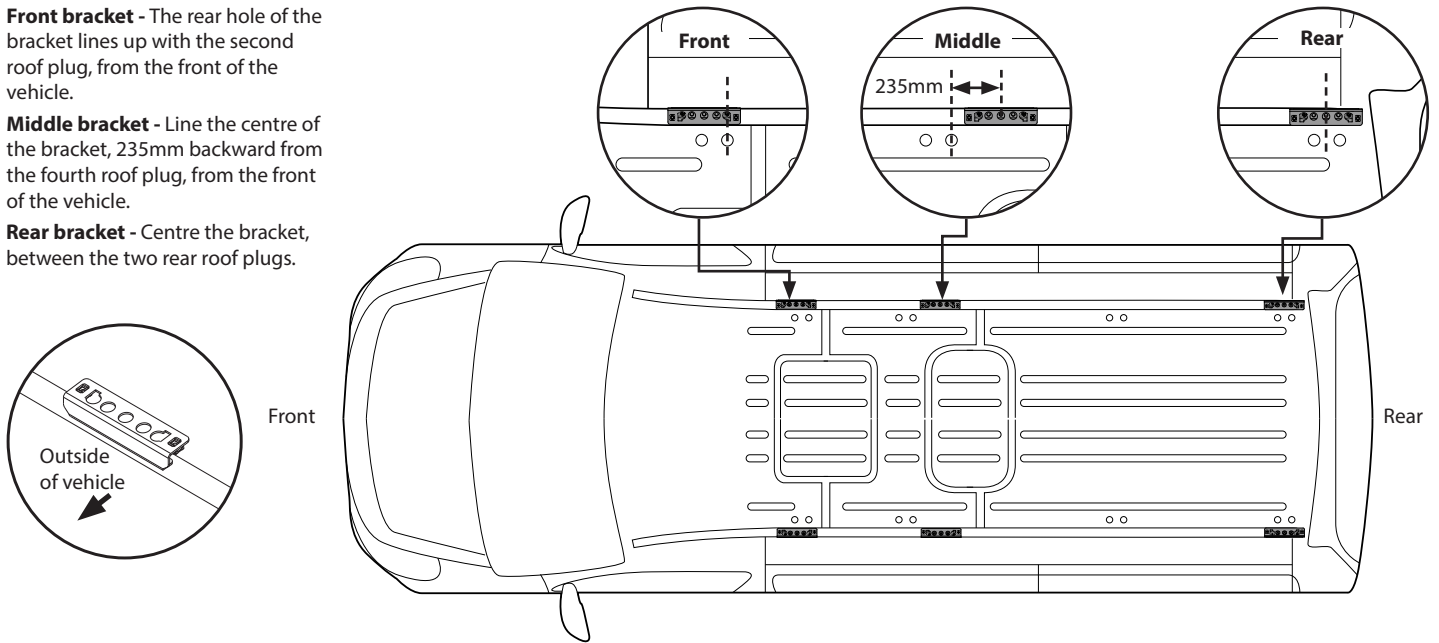

### Step 2

With the brackets in place, use a marker to indicate drilling positions as shown.

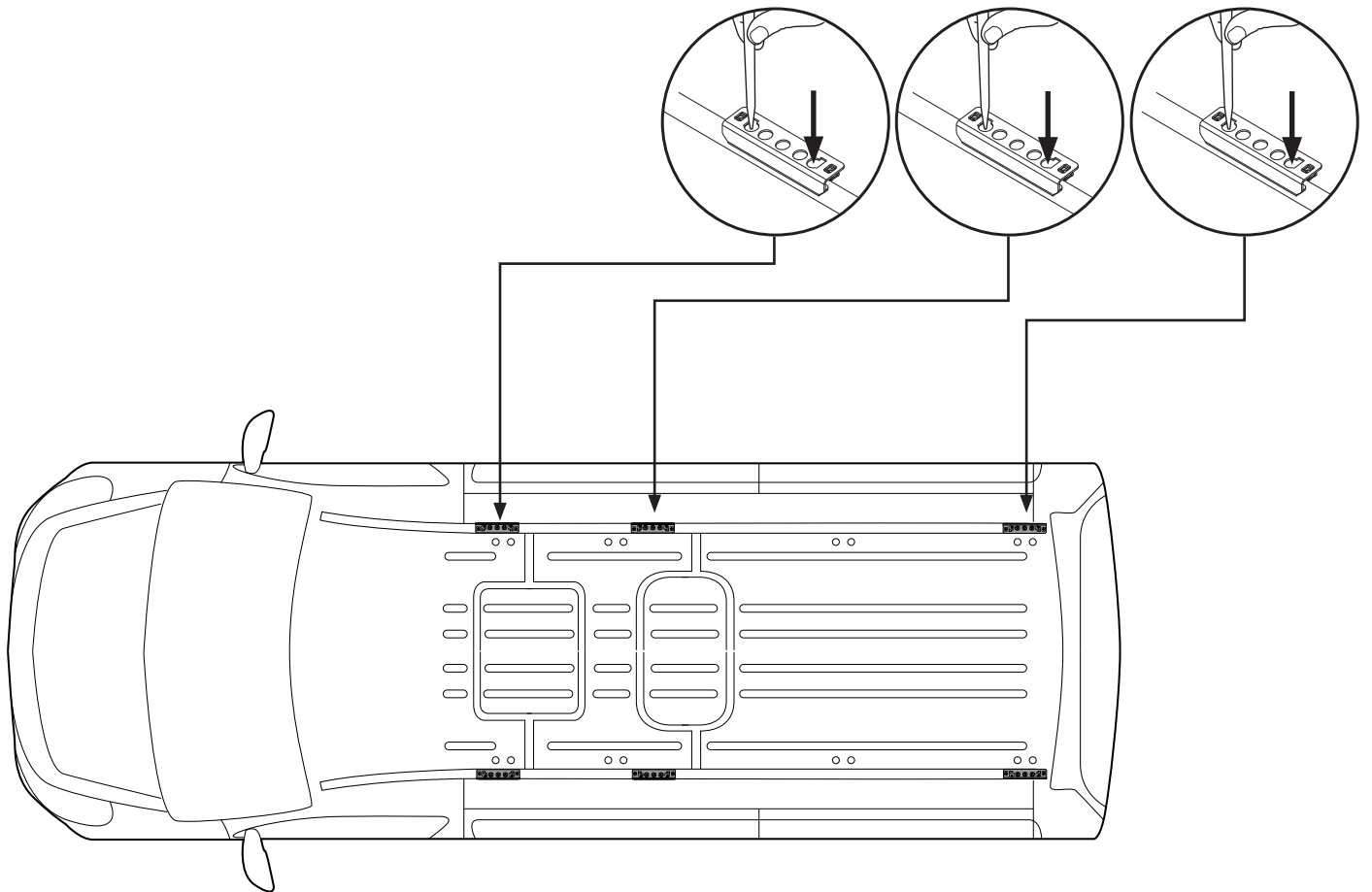

Step 3

Pilot drill with a 3mm bit, then using a 6.5mm drill bit and a depth gauge set to 5mm, carefully drill through your roof references. **Note:** It is advised to drill the rear left and front left bracket with assistance. Loom wiring is present under these drilling locations. Apply tape in the approximate drilling location to capture swarf. An assistant should pull wiring out of the way during drilling.

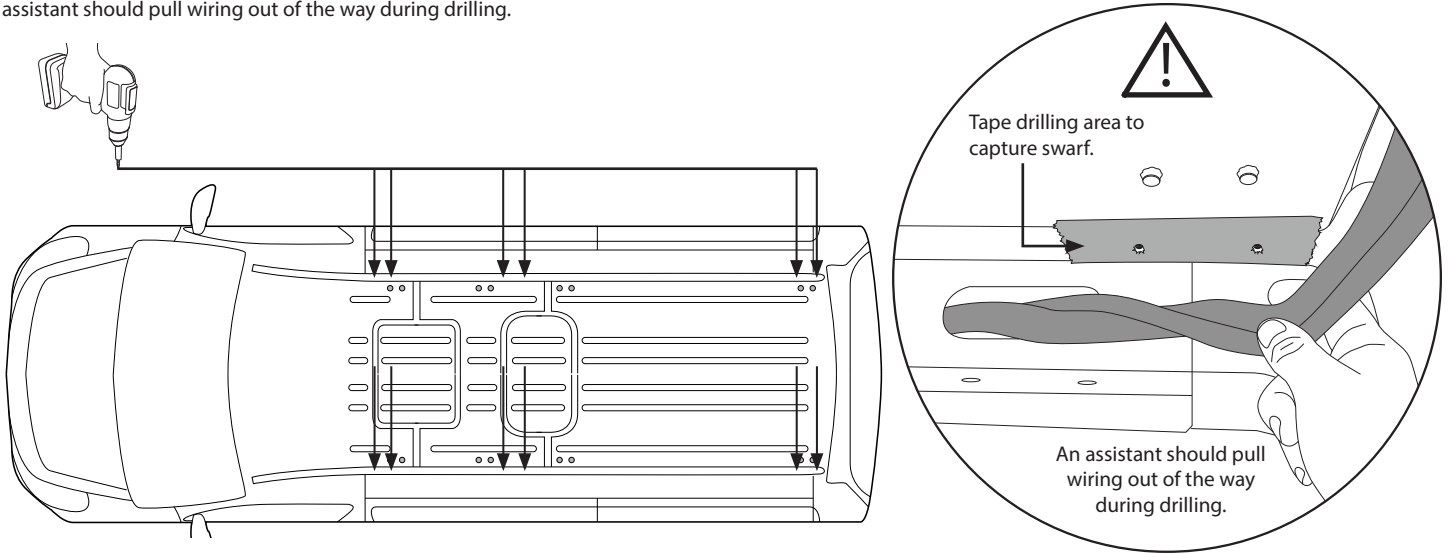

Step 4

Vacuum any swarf from the roof caused by drilling.

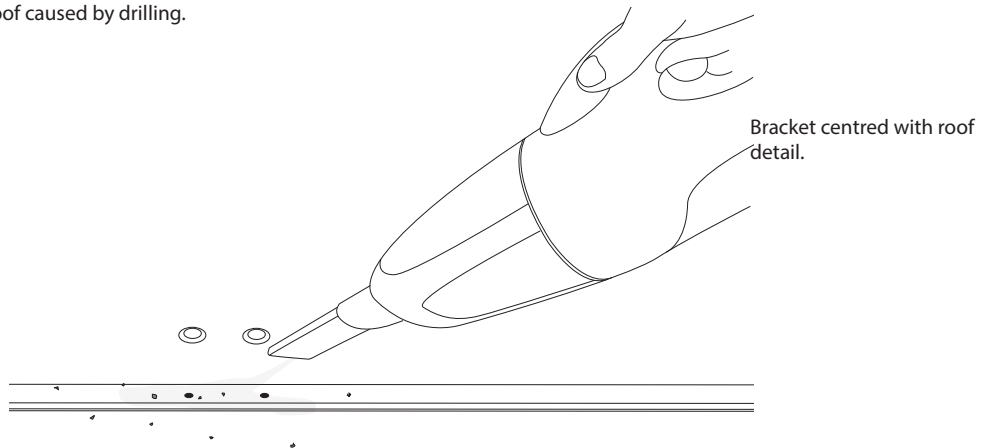

Step 5

Apply cold galvanising paint to the holes drilled. Allow time to dry. Using butyl mastic, apply a water seal to the holes drilled.

Apply cold galvanising paint to the roof where drilled.

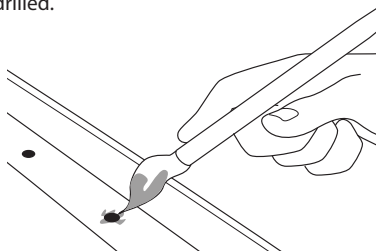

Apply cold galvanising paint to the underside of the roof where drilled.

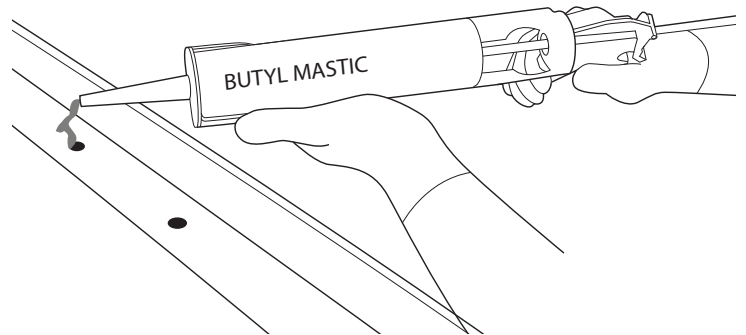
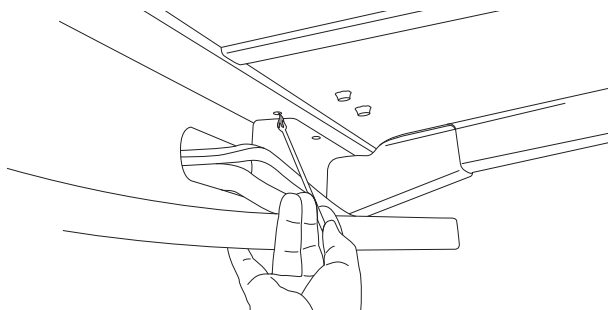

Step 6

Place the brackets onto the roof and fix in place with M6 hardware. Tighten with a an 10mm socket and the allen key provided. For crossbar fitment turn to page 7.

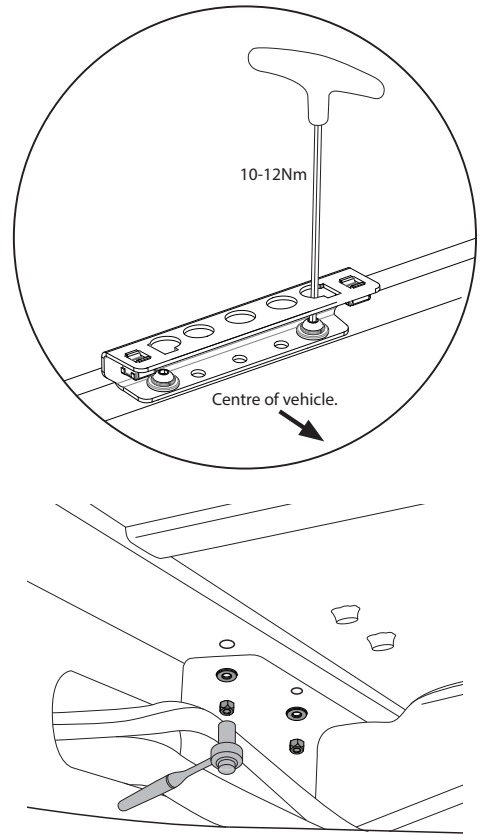
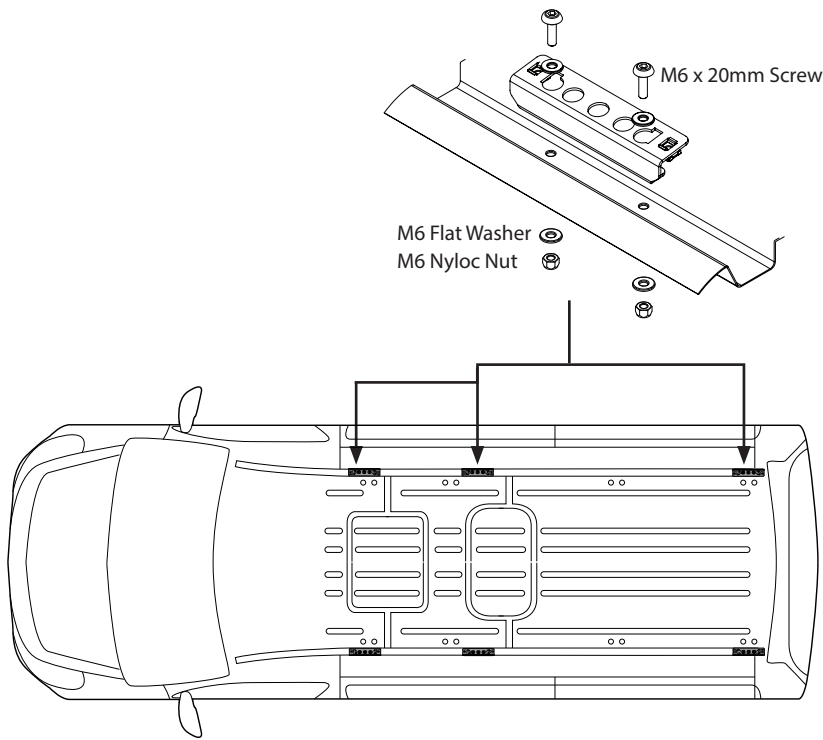

4 Crossbar System step 1

Move to the roof of the vehicle. At the measurements indicated, place a bracket.

**Front bracket** - The rear hole of the bracket lines up with the second roof plug, from the front of the vehicle.

**Middle brackets (A/B)**- Line the centre of the bracket, between the factory plugs as shown.

**Rear bracket** - Centre the bracket, between the two rear roof plugs.

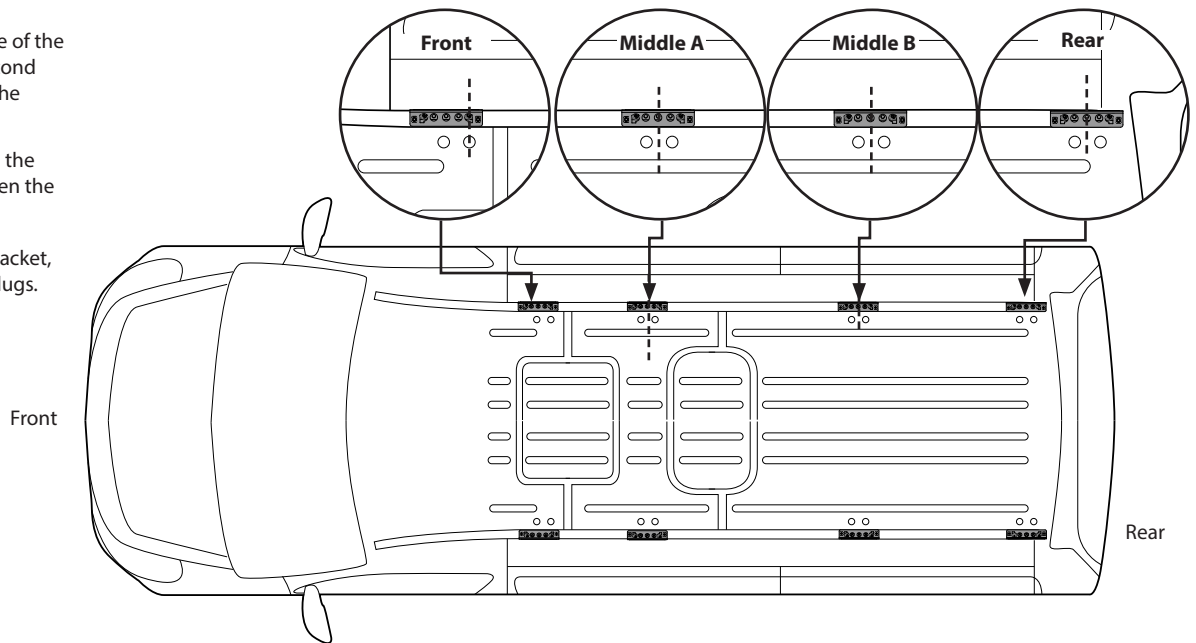
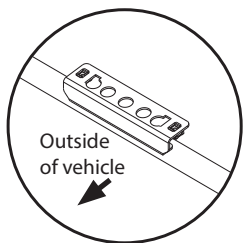

Step 2

With the brackets in place, use a marker to indicate drilling positions as shown.

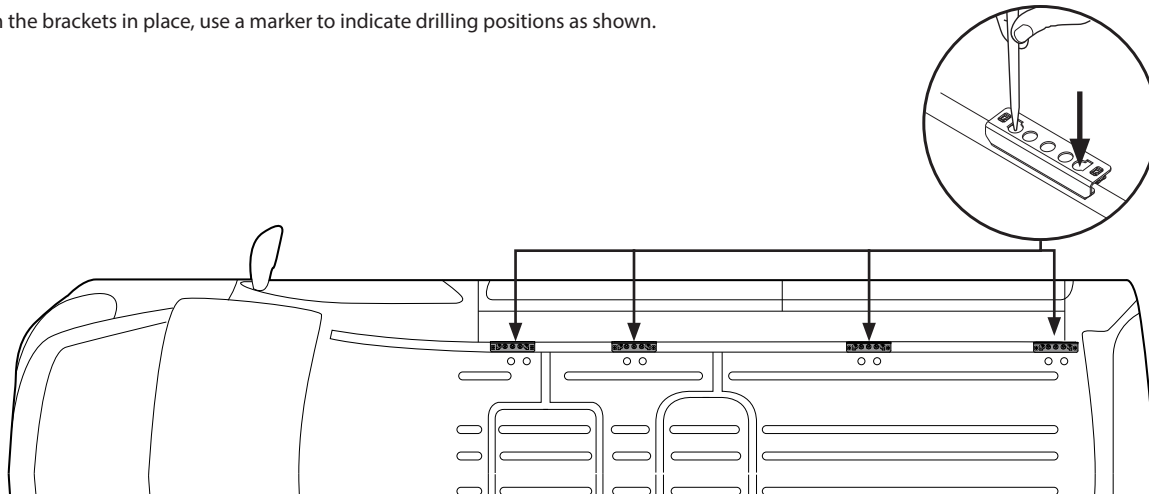

Step3

Pilot drill with a 3mm bit, then using a 6.5mm drill bit and a depth gauge set to 5mm, carefully drill through your roof references.

**Note:** It is advised to drill the rear left and front left bracket with assistance. Loom wiring is present under these drilling locations. Apply tape in the approximate drilling location to capture swarf. An assistant should pull wiring out of the way during drilling.

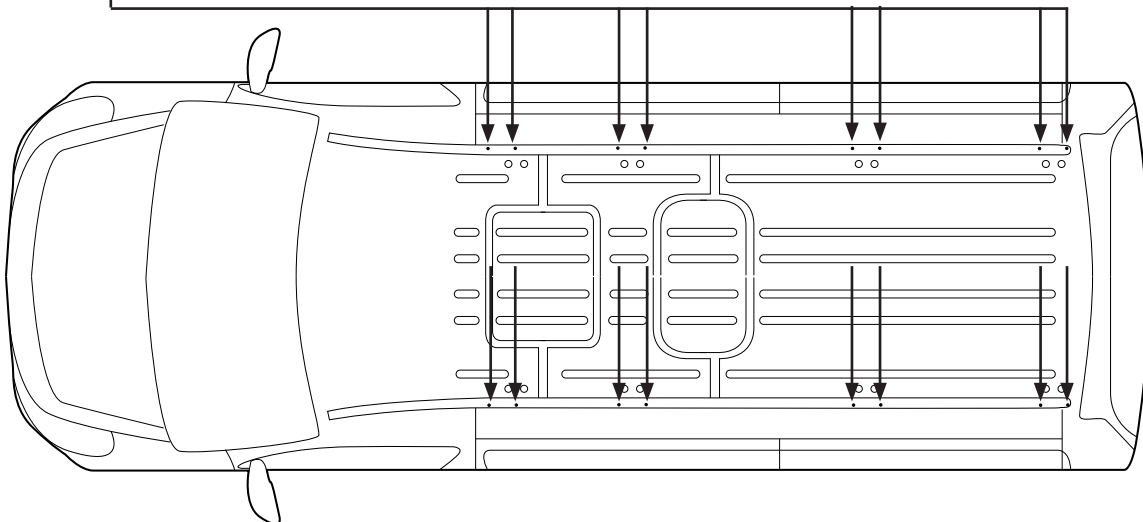
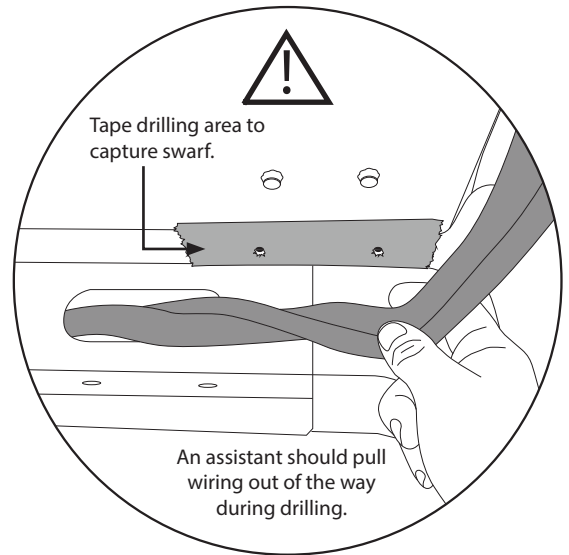
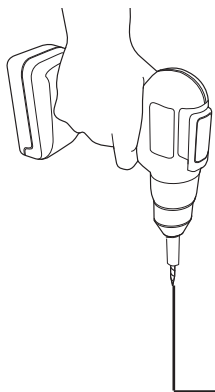

Step 4

Vacuum any swarf from the roof caused by drilling.

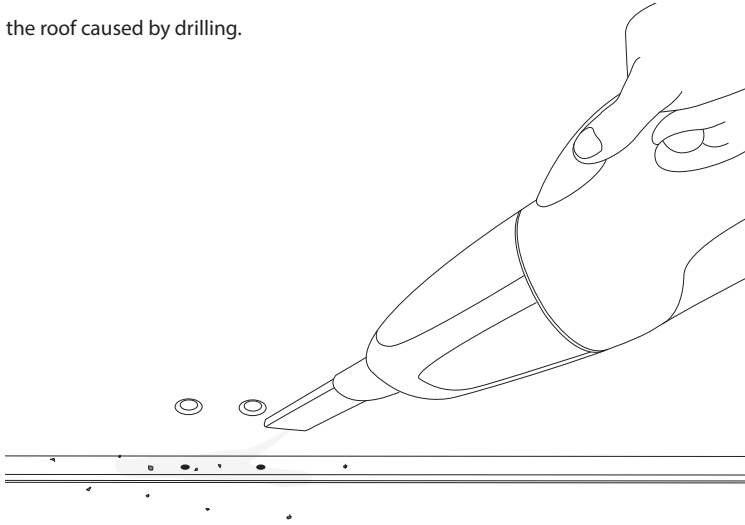

Step 5

Apply cold galvanising paint to the holes drilled. Allow time to dry. Using butyl mastic, apply a water seal to the holes drilled.

Apply cold galvanising paint to the roof where drilled.

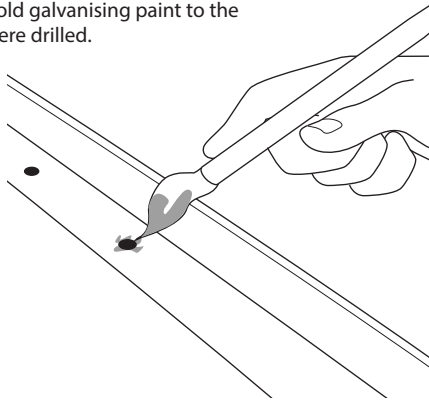

Apply cold galvanising paint to the underside of the roof where drilled.

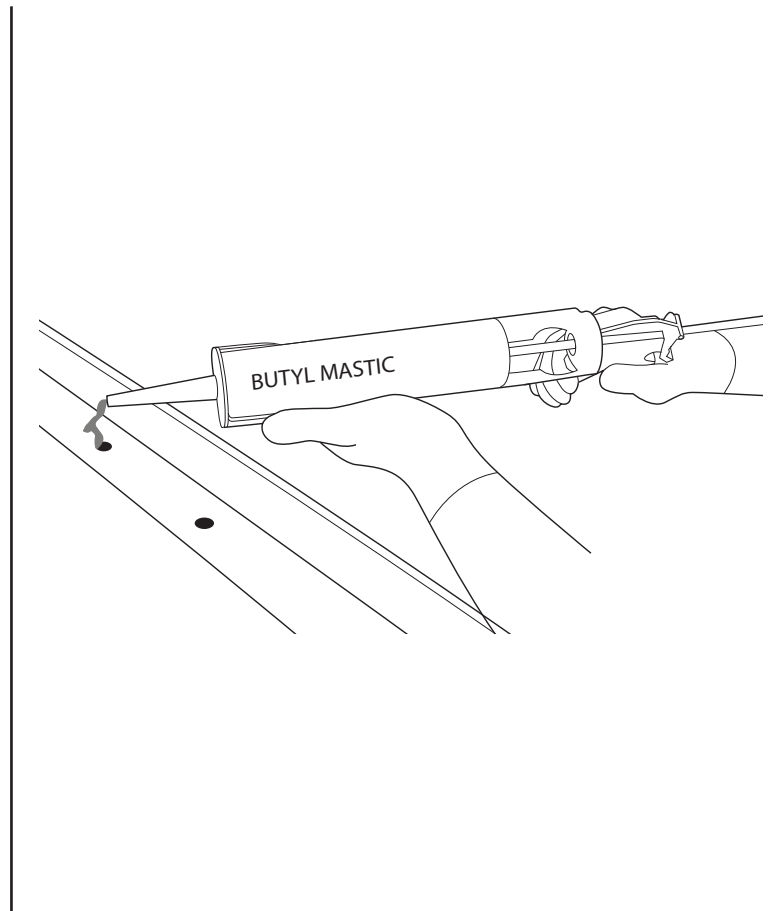
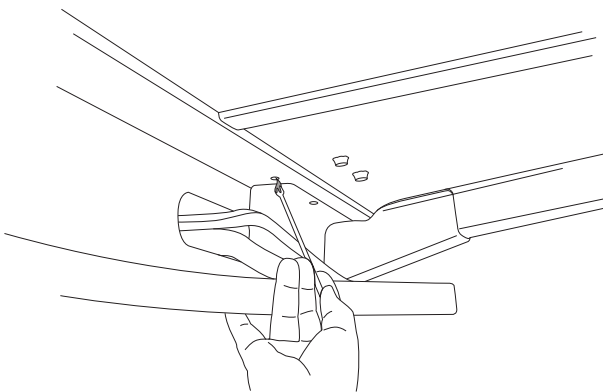

Step 6

Place the brackets onto the roof and fix in place with M6 hardware. Tighten with a an 10mm socket and the allen key provided.

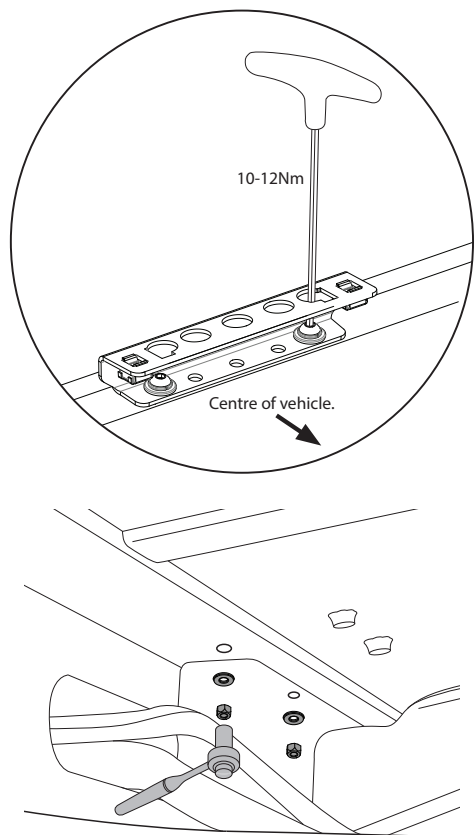
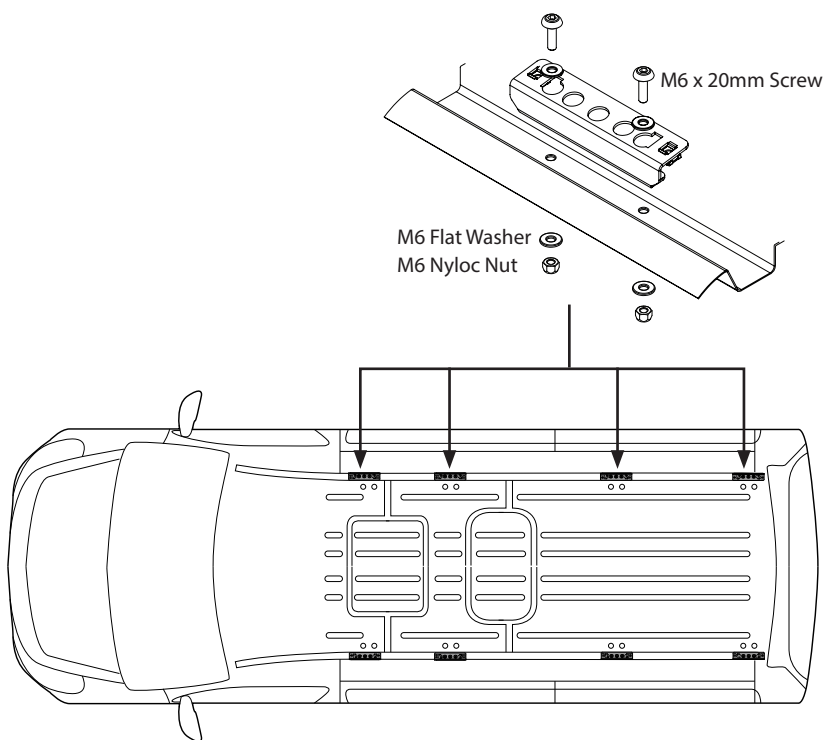

Crossbar fitment

Complete crossbar mount kits as specified in their instructions. Place the crossbars onto the installed brackets in the roof. Fix in place with the M6 hardware provided and tighten with the allen key provided.

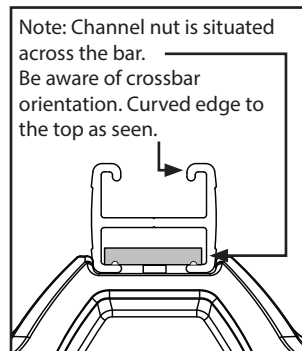
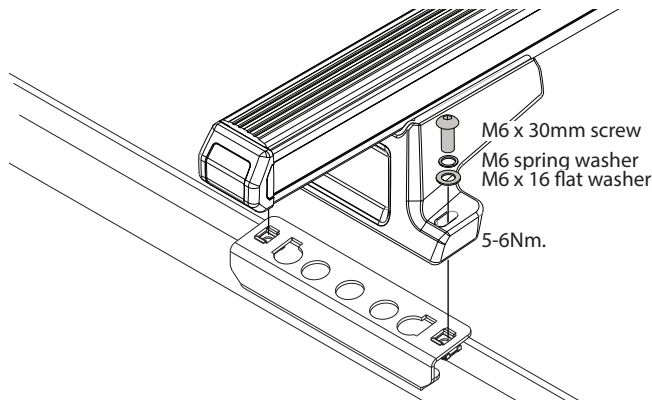

NOTE

**ATTENTION:**  
Thoroughly check all fasteners are secure before driving away. Heights are for standard unloaded vehicles.  
Always check your specific vehicles height.

