

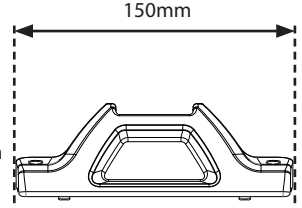

'Tradie Tuff'

COMMERCIAL ROOF RACKS

MOUNT KITS 45mm & 85mm

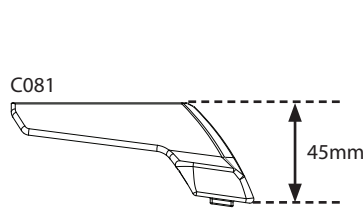
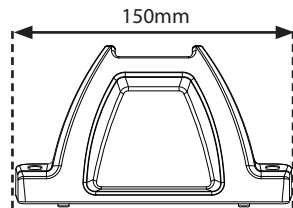
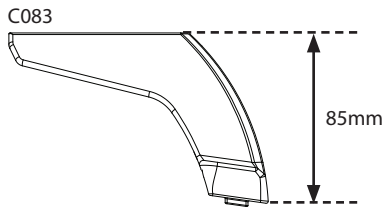
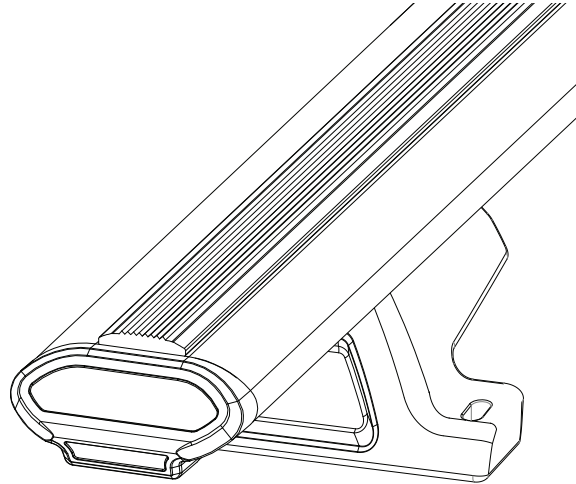
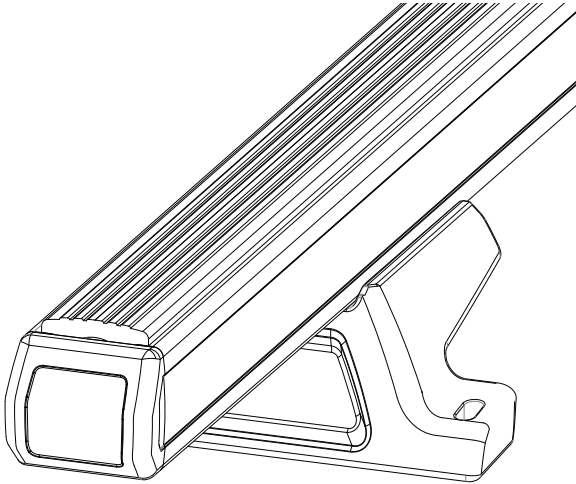

Note:

- PLEASE READ INSTRUCTIONS AND CHECK CONTENT PRIOR TO INSTALLING.
- PLACE INSTRUCTIONS IN VEHICLES GLOVE COMPARTMENT AFTER INSTALLING.



Bar maximum capacity: Check vehicle's manufacturers handbook for load limit.

Tested to AS/NZS 1235-2000 ADR standards

- Please check your vehicle's manual for vehicle load capacity (please do not exceed the lowest load rating) and please download and read our Load Rating guide which can be found on our website vas.com.au.
- Load rating is based on driving on sealed roads to road conditions and includes weight of the roof rack system.

Important information

- Complete maintenance checks weekly including bolt connections and tightness.
- Heavy loads carried near feet
- Overhanging loads should conform to relevant state laws
- Check tie down strap tension every 50klm as loads can shift
- Specialised equipment carriers such as ladder slides should be used
- Ensure your roof racks, ladder rails and or load does not inhibit the tailgate lifting on vehicles manufactured with these doors
- Check car park heights before entering
- Keep load under the maximum capacity
- Use non stretch fastening straps
- Remove roof racks prior to using an automatic car wash

Note: The handling characteristics of a vehicle will change when a carrier system is fitted. Driving technique such as speed reduction, cornering techniques and braking distances should be altered to allow for these changes.

Kit Inclusions

Item	Hardware Part List	1 Bar	2 Bar	3 Bar
1	M10 hex bolt - F025	2	4	6
2	M10 spring washer - F034	2	4	6
3	M10 flat washer - F033	2	4	6
4	M10 channel nut - F035	2	4	6
5	4mm allen tool - C028	1	1	1
6	End cap - C124	2	4	6

A*- C083 85mm Leg (x2,x4,x6)

B*- C081 45mm Leg (x2,x4,x6)

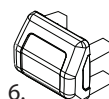
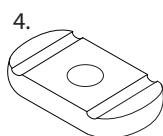
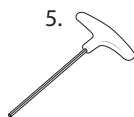
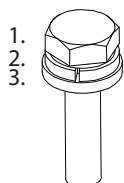
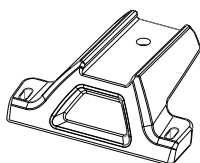
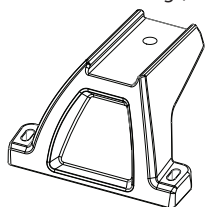

Tools Required

17mm Spanner.

Required kits (as separate):

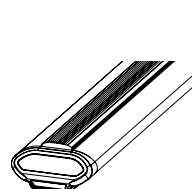

Or

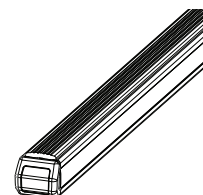

VAS

21 Hallmark Street, Pendle Hill
NSW 2145, Australia
+61 2 9631 0555
vas.com.au

Document No: D-041

Issue No: 02

Step 1

Place the leg onto the installed bracket on the roof of the vehicle.
Install the hardware as shown.

Tighten with the 4mm
T handle allen tool to
4-5Nm.

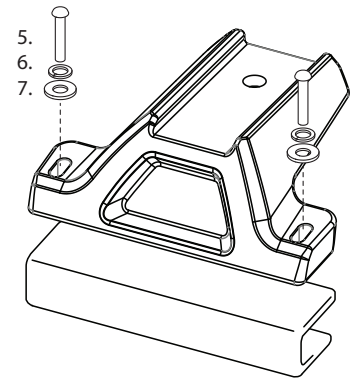
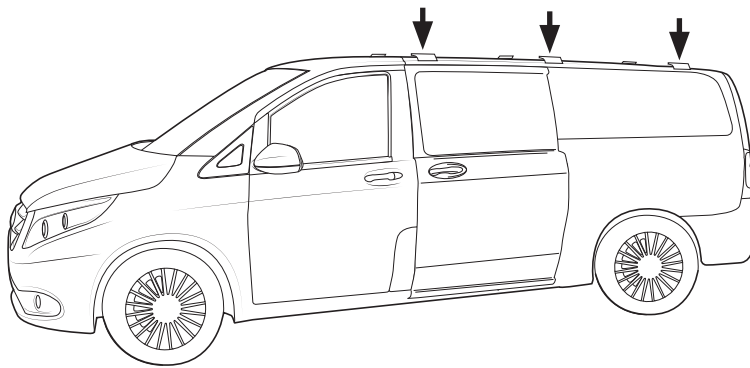

Step 2

Install the leg crossbar connecting hardware as shown. Place the crossbars onto the legs, making sure the channel nut is situated across the bar, holding it in place. Finger tighten only.

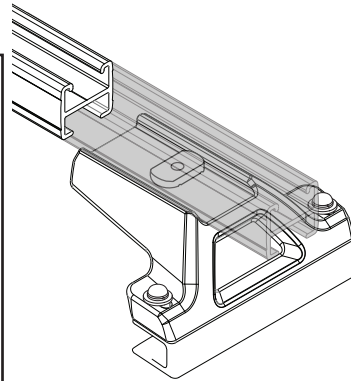
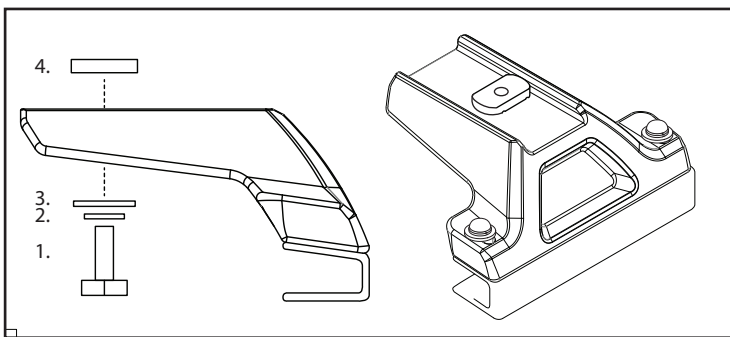

Note: Channel nut is situated
across the bar.
Be aware of crossbar
orientation. Curved edge to
the top as seen.

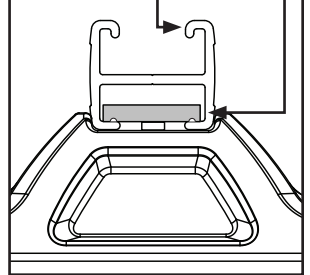

Step 3

Ensure the crossbars are evenly spaced. Tighten in place using an
17mm wrench.

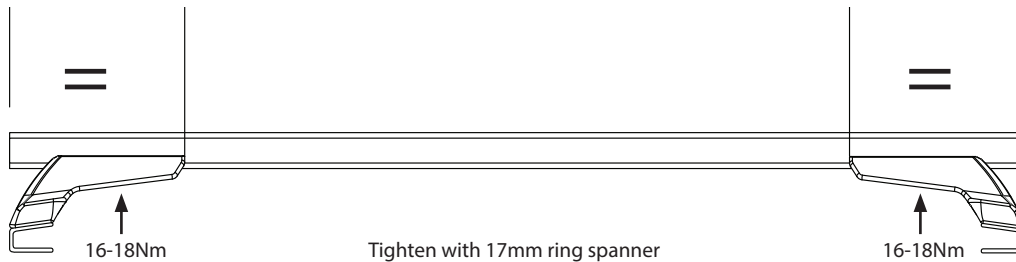

Step 4

Insert end caps and rubber strips. Observe the orientation of the
end caps.

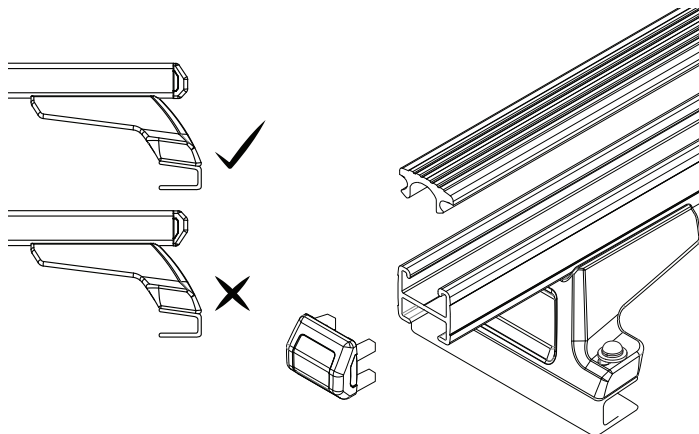

Note: If rubber is too long, cut to length.

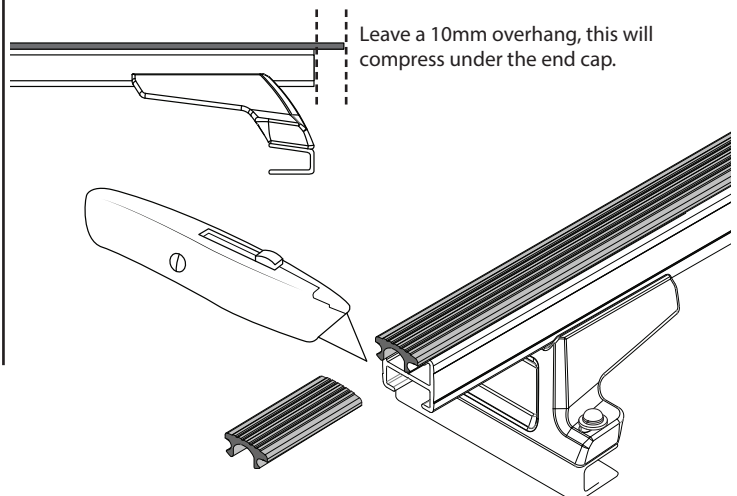

Note

Spacer kits are available and extend the height of your crossbars up to 40mm. Please refer to your specific vehicle instructions for further details.

