



Fitting & Assembly Instructions

Heavy Duty Start Frame 4, 8 or 10 Collection with Shelves

HD Start Frame 4, 8 or 10 Collection Fit Kit Contents:

- 1 X VAS Shelving System Crossbar (See Fig.A)
- 2 X VAS Shelving System Upright (See Fig.B)
- 2 X Pivot 'U' Bracket (See Fig.C)
- 2 X Pivot Arm Bracket (See Fig.D)
- 2 X Cant Rail Strengthening Bracket (See Fig.E)
- 2 X Insert Plate (See Fig.F)
- 4 X 14 gauge x 1 $\frac{3}{4}$ " Self-Tapping Screws
- 2 X $\frac{1}{4}$ " x 1 $\frac{3}{4}$ " Bolts (Extension Frame Only)
- 4 X $\frac{1}{4}$ " x 1 $\frac{1}{2}$ " Bolts
- 4 X $\frac{1}{4}$ " x 1" Bolts
- 4 X $\frac{1}{4}$ " x $\frac{5}{8}$ " Bolts
- 10 X 8g Self-Drilling Screws
- 32 X Dog Head Screws
- 12 X $\frac{1}{4}$ " Nyloc Nuts
- 4 X $\frac{1}{4}$ " Spring Washers

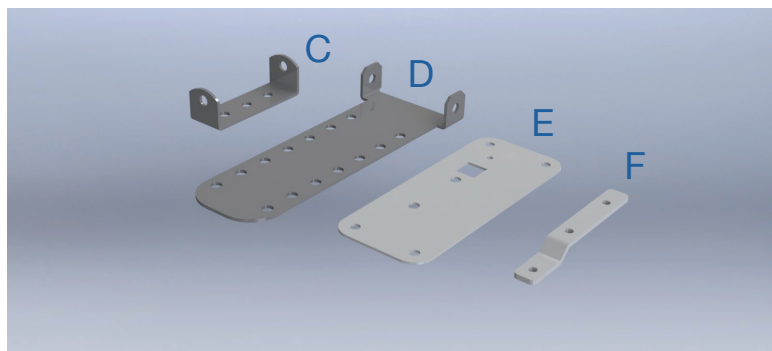
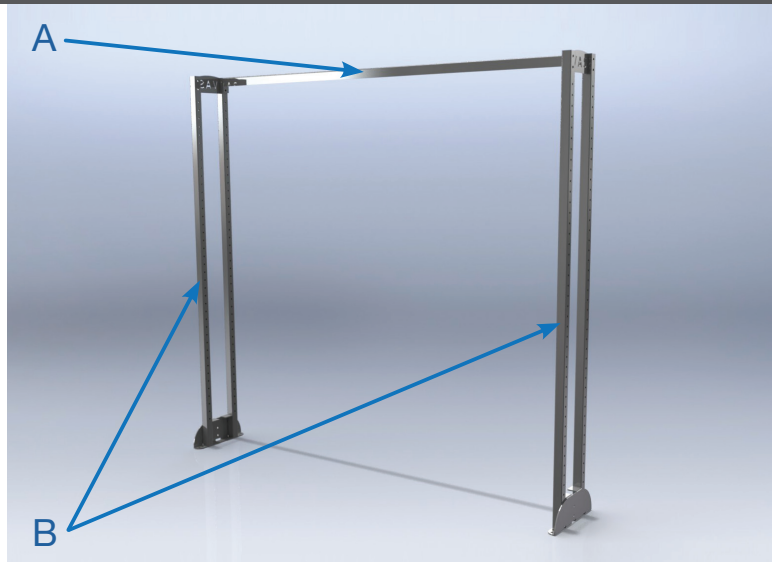

Instructions:

STEP 1.

Step 1: Assemble the VAS Shelving System frame, 2 X upright and 1 X crossbar using 4 X $\frac{1}{4}$ " x 1 $\frac{1}{2}$ " bolts and Nyloc nuts. Position the assembled VAS Shelving System frame in the vehicle.



Instructions (Continued):

STEP 2.

Step 2: Attach the pivot 'U' bracket to the pivot arm using 2 X 1/4" x 5/8" bolts and 1/4" Nyloc nuts, to use as marking template.

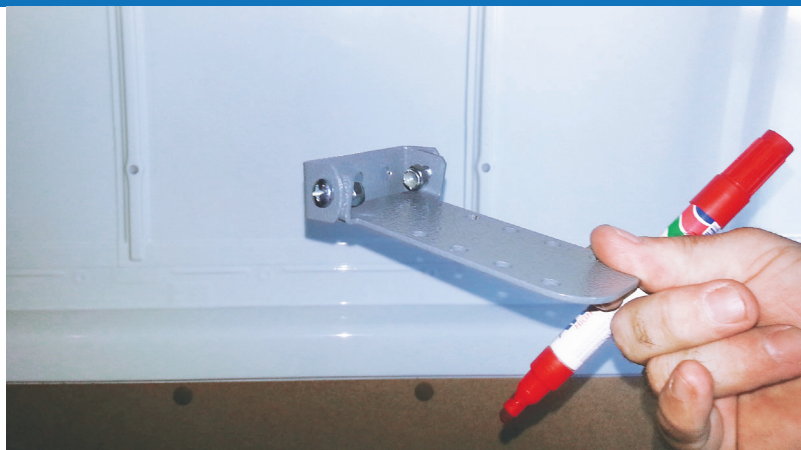

STEP 3.

Step 3: Line up the holes in pivot plate with the holes in the VAS Shelving System crossbar. With a marking pen, mark where the holes in the pivot 'U' bracket locate on the cant rail in your vehicle. Try to stay clear of the joins in panels.



STEPS 4 & 5.

Step 4: Repeat this in two positions (preferably one at each end of the VAS Shelving System cross bar).

Step 5: Remove the VAS Shelving System frame from the vehicle.

Instructions (Continued):

STEP 6.

Step 6: Using the cant rail plate, mark with your marking pen 40mm vertical lines, in line with the marks you have already made.



STEP 7.

Step 7: Line up the cant rail plate with the vehicle's cant rail using the two small holes - you will see the lines that you marked through the holes in the cant rail plate. Attach the cant rail plate in position using 4 X 8 gauge self-drilling screws. Repeat this for all mounting positions.



STEP 8.

Step 8: Drill holes using a 7.5mm drill bit (if you do not have a drill stop you can use tape around the drill bit, as show in the image to the right). This is to prevent you from drilling through to the outside of your vehicle.



Instructions (Continued):

STEP 9.

Step 9: Using a step drill (if you don't have a step drill you can use a 16mm hole saw), drill out the larger square hole to fit the insert plate through.



STEP 10.

Step 10: Put the insert plate in and attach with 2 X 1/4" x 1" bolts. Using an 8 gauge self-drilling screw, attach the insert plate to the cant rail through the 4mm hole at the end of the insert plate.



STEP 11.

Step 11: Remove 2 X 1/4" x 1" bolts from the insert plate and then attach the pivot 'U' bracket and tighten, using 2 X 1/4" x 1" bolts and 1/4" washer. Attach the pivot arm to the 'U' bracket using 2 X 1/4" x 5/8" bolts and 1/4" Nyloc nuts. Leave loose at this stage.



Instructions (Continued):

STEP 12.

Step 12: Repeat steps 8, 9, 10 & 11 for the remaining anchor points.



STEP 13.

Step 13: Sweep or air blow out all debris from the floor of the vehicle.



STEP 14.

Step 14: If you have flooring for the vehicle, now is a good time to put it in. Place the VAS Shelving System frame back in the vehicle and attach the pivot bracket arms loosely to the VAS Shelving System frame (the pivot bracket arm will be tightened later).



Instructions (Continued):

STEP 15.

Step 15: Using a P3 Phillips Head bit, attach the bottom shelf to the VAS Shelving System frame using 8 X Dog Head screws.



STEP 16.

Step 16: Using a right angle square, make sure the VAS Shelving System upright is square with the floor. It is a good idea to use a piece of ply to sit square on the floor.

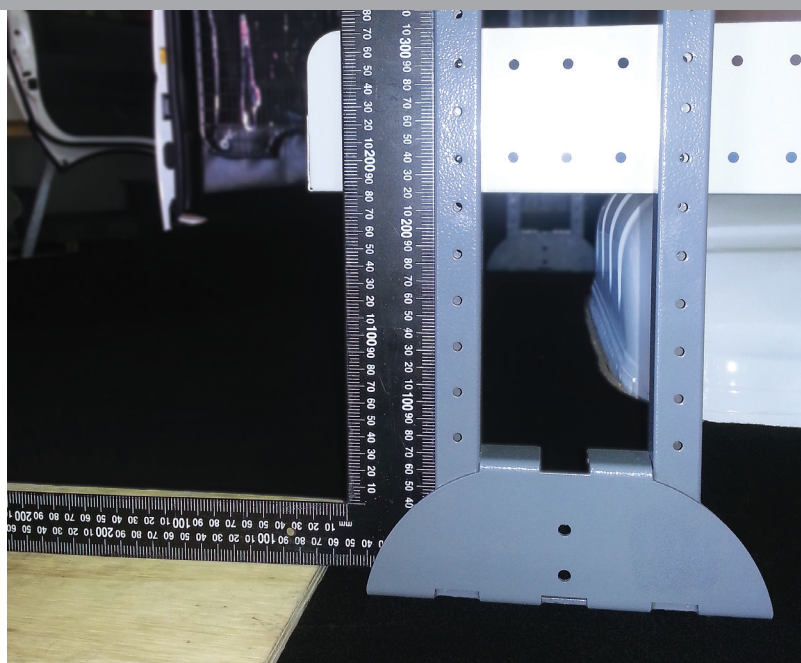

STEP 17.

Step 17: Using 14 gauge x 1¾" self-tapping screws, attach the feet to the vehicle floor. If using an impact gun, there is no need to pre-drill.

Note: Please be aware of what is under your vehicle. i.e. brake line, fuel tank, spare tyre, etc.



Instructions (Continued):

STEP 18.

Step 18: Repeat step 17 for the remainder of the VAS Shelving System uprights. The VAS Shelving System is now securely attached to the vehicle floor.

STEP 19.

Step 19: Tighten all of the top mounting brackets. The VAS Shelving System will now be securely anchored to the cant rail of the vehicle.



STEP 20.

Step 20: Using a P3 Phillips head bit, secure the remaining shelves using Dog Head screws as shown in Step 15.

Note: If the VAS Shelving System extension frame is being used (as shown), join the extension frame to the start frame using $\frac{1}{4}$ " x $1\frac{3}{4}$ " bolts. They will be supplied in additional fitting kit.

